

Diffuse reflection

PD-F41UA

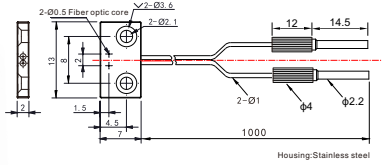

Housing:Stainless steel
Sensing distance:
Minimum bending radius: R2 PC1:80mm
Min-size Detected object: ϕ 0.05mm PG1:30mm

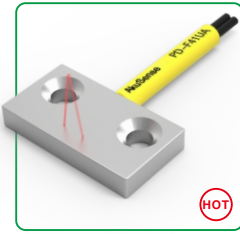

PD-F42UA

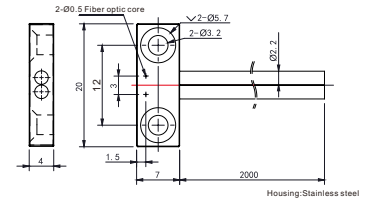
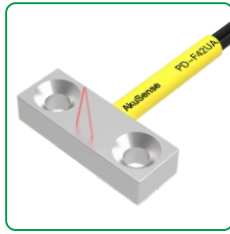

Housing:Stainless steel
Sensing distance:
Minimum bending radius: R2 PC1:160mm
Min-size Detected object: ϕ 0.05mm PG1:120mm

PD-F44UA

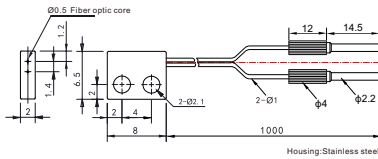
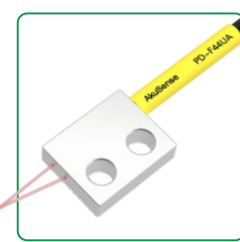

Housing:Stainless steel
Sensing distance:
Minimum bending radius: R2 PC1:120mm
Min-size Detected object: ϕ 0.05mm PG1:55mm

PD-F47UA

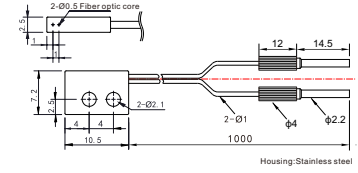
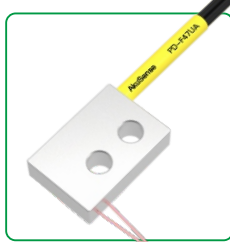

Housing:Stainless steel
Sensing distance:
Minimum bending radius: R2 PC1:80mm
Min-size Detected object: ϕ 0.05mm PG1:25mm

Thru-beam

PT-F51UA

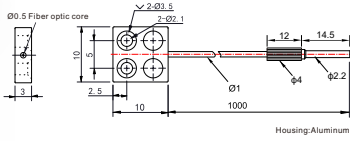
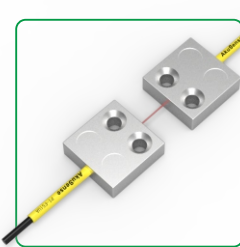

Housing:Aluminum
Sensing distance:
Minimum bending radius: R2 PC1:400mm
Min-size Detected object: ϕ 0.05mm PG1:130mm

PT-F52UA

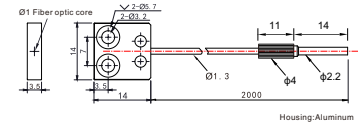
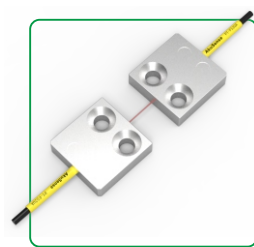

Housing:Aluminum
Sensing distance: 1900mm
Minimum bending radius: R2
Min-size Detected object: ϕ 0.05mm
(Sensing distance varies with different amplifiers)

PT-F53UA

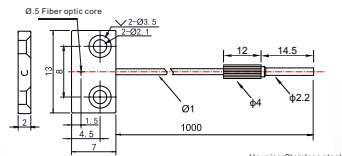
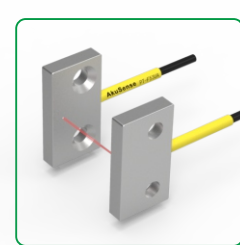

Housing:Stainless steel
Sensing distance:
Minimum bending radius: R2 PC1:210mm
Sensing distance: 340mm
Min-size Detected object: ϕ 0.05mm
(Sensing distance varies with different amplifiers) PG1:80mm

PT-F54UA

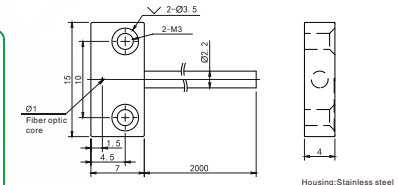
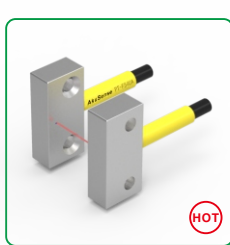

Housing:Stainless steel
Sensing distance:
Minimum bending radius: R2 PC1:1300mm
Min-size Detected object: ϕ 0.05mm PG1:450mm

PT-F57UA

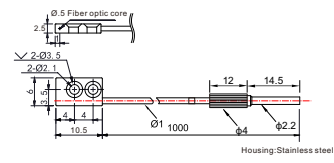
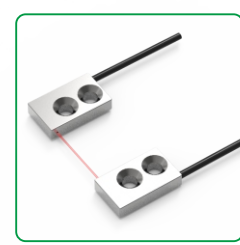

Housing:Stainless steel
Sensing distance:
Minimum bending radius: R2 PC1:400mm
Sensing distance: 480mm
Min-size Detected object: ϕ 0.05mm
(Sensing distance varies with different amplifiers) PG1:100mm

PT-FZ8

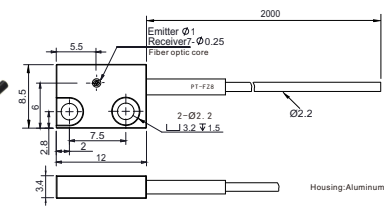
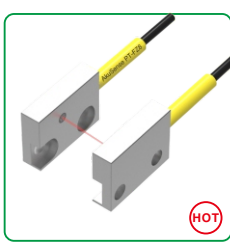

Housing:Aluminum
Sensing distance:
Minimum bending radius: R15
Sensing distance: 120mm
Min-size Detected object: ϕ 0.1mm
(Sensing distance varies with different amplifiers)

- Fiber Optic
- Slot Sensors
 - Photoelectric
 - Laser
 - Proximity
 - Displacement
 - Magnetic
 - Contact
 - Area
 - Ultrasonic
 - Vision
 - Vibration
 - Temperature
 - Annexes

- Guidance
- Fiber amplifiers
 - Standard economical
 - High stability
 - High performance type
 - High speed response

- Fiber components
- Popular type
 - Array-type
 - Flat bracket type
 - Side-view type
 - High elastic type
 - High temperature resistant
 - Small spot type
 - Combination type
 - High end type

- Fiber lens
- Fiber lens

*PG1: TEGA with a threshold setting of 200;
PC1: 7-step with a threshold setting of 200.
*Cable length listed above can be customized.